

SERIES CATALOGUE

unika



CORE DRILL

Safety Precautions



WARNINGS

- Wear working clothes suitable for the operation. In particular, eye protection equipment must be worn to prevent shavings from getting into your eyes.
- Prepare the working environment before starting the job. Be careful to consider safety when working in high places, being close to inflammable materials, in dark places, in rain, in wet place, on scaffolding. Consider falling, fires, electric shock, etc.
- Be sure to check if there are any defects in the product before use. Never use the product if it has any defect.
- Be sure to turn off the main switch of the drill and disconnect the power supply plug from the socket before attaching and detaching the product.
- Do not touch the product, the shavings, or the drilled surface by hand because they may be hot by drilling friction.
- Never remodel or modify the product.
- Do not touch moving parts, especially the drill tip or blades.
- When you feel anything unusual in use, stop using the product and inspect it as well as the electrical drill.
- When using the product for any other application than is specified, be sure to contact UNIKA.
- Carefully read the instruction manual of the electrical drill used before using the product.







CAUTION

- Do not allow any person other than the working staff to enter the working place.
- Do not touch the blades by hand because they are very sharp.
- Please read handling description well when changing and assembling.
- Use spare parts that comply with the product specification.
- The product and its size must be appropriate for the specification of the electrical drill used.

The products carried by this catalog, specifications, etc. may be changed without preliminary announcement .
The products carried in this catalog may be different in color than the actual item.

CORE DRILLS

Single-function Core Drill E&S VC Type (Percussion)		4	Braze Diamond Core Drill VPC Type (For PVC Pipe)		10
Single-function Core Drill E&S RC Type (Rotation)		5	Braze Diamond Core Drill FAN Type (For Ventilating Fan)		11
Single-function Core Drill E&S ALC Type (ALC)		6	Diamond Core Drill DC Type		12
Single-function Core Drill E&S DC Type (Dry Diamond)		7	Rotary Hammer Core Drill LHC Type		13
Single-function Core Drill E&S MC Type (Multi)		8	Hammer Core Drill HC Type		14
Single-function Core Drill E&S FC Type (Compound Material)		9			

CORE DRILLS USAGE CHART

	CONCRETE	BLOCK / BRICK	MORTAR	SLATE	ALC	JAPANESE WALL	HARD EXTERIOR PANEL	SOFT EXTERIOR PANEL	PLASTERBOARD	STONE	ARTIFICIAL MARBLE	ROOF TILE	CERAMIC TILE	PORCELAIN TILE	PLASTICS	PVC	FRP	VU PIPE	PVC PIPE	FRP/PIPE	HUME PIPE	CERAMIC PIPE	WOOD/PLYWOOD	STEEL/ALUMINUM	METAL SIDING PANEL	2x4's including nails	STAINLESS STEEL	
E&S VC (Percussion)		⊙	⊙	○		○	○	○	○					△														
E&S RC (Rotation)		○		⊙		○		○	○			○		△	○	⊙						○						
E&S ALC (ALC)					⊙				○																			
E&S DC (Dry Diamond)	⊙	○	⊙	○			⊙	○		*○	⊙	○	*○	○							○							
E&S MC (Multi)							○	⊙	⊙							⊙	⊙											
E&S FC (Compound Material)								△	○							⊙	⊙						⊙	⊙	⊙	⊙	○	
BRAZE Diamond VPC Type							○	○	○		○						○	○	○	○								
BRAZE Diamond FAN Type					⊙		⊙	⊙	⊙		○						○	○	○	○								
Diamond Core Drill DC Type	⊙	○	⊙	○	○		⊙	○		⊙	⊙	○	○	○														
Rotary Hammer Core Drill LHC Type	⊙	⊙	⊙	○																								
Hammer Core Drill HC Type	⊙	○																										

*Use water for cooling the cutting edge when drilling ceramic tiles and stone.

CORE DRILLS

Single-function
Core Drill

E&S VC Type



- Applying vibration and rotation to the cutting edge enables speedier drilling by crushing the work material while drilling.
- A wide lineup of diameter sizes of 22 mm to 220 mm.
- Uses "10 mm/13 mm chuck combination shank" allowing most drill chucks.
- SDS shanks are also available at the same price.

*Use the rotation mode for plasterboards and soft siding boards.

Effective Length	Please refer to the spec table.
Applicable Electric Tool	Percussion Drill

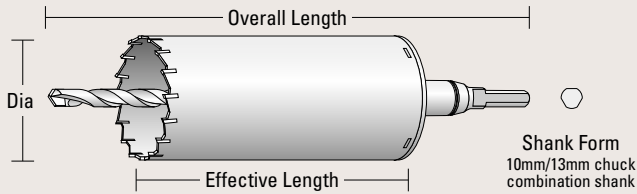

Percussion



BLOCK / BRICK	MORTAR
SLATE	JAPANESE WALL
*PLASTERBOARD	EXTERIOR PANELS

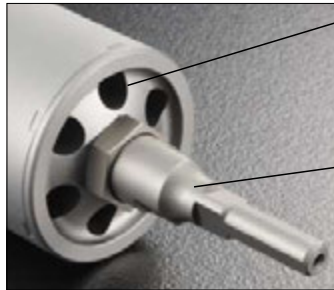

- Equipped with "drilling swarf discharge holes" in consideration of debris. Drilling swarf discharge holes for drills with a diameter of 22 - 38 mm positioned on the body side surface.
- "10mm/13mm chuck combination shank" allows for most drill chucks.

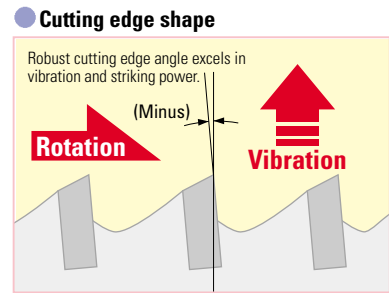

ES-V (Straight-Shank)				
	Code	Diameter (mm)	Overall Length (mm)	Effective Length (mm)
	ES-V22ST	22	235	135
	ES-V25ST	25	270	150
○	ES-V29ST	29		
○	ES-V32ST	32		
	ES-V35ST	35		
○	ES-V38ST	38		
	ES-V40ST	40	269	135
	ES-V45ST	45		
○	ES-V50ST	50		
	ES-V55ST	55		
	ES-V60ST	60		
◎	ES-V65ST	65		
△	ES-V70ST	70		
	ES-V75ST	75		
△	ES-V80ST	80		
	ES-V85ST	85		
	ES-V90ST	90		
	ES-V95ST	95	269	135
	ES-V100ST	100		
	ES-V105ST	105		
△	ES-V110ST	110		
	ES-V120ST	120		
	ES-V130ST	130		
	ES-V150ST	150		
	ES-V155ST	155		
	ES-V160ST	160		
	ES-V170ST	170		
	ES-V200ST	200		
	ES-V220ST	220		

ES-V (SDS-Shank)				
	Code	Diameter (mm)	Overall Length (mm)	Effective Length (mm)
	ES-V25SDS	25	283	150
△	ES-V29SDS	29		
◎	ES-V32SDS	32		
○	ES-V35SDS	35		
◎	ES-V38SDS	38		
	ES-V40SDS	40	282	135
	ES-V45SDS	45		
◎	ES-V50SDS	50		
	ES-V55SDS	55		
△	ES-V60SDS	60		
◎	ES-V65SDS	65		
○	ES-V70SDS	70		
	ES-V75SDS	75		
△	ES-V80SDS	80		
	ES-V85SDS	85		
	ES-V90SDS	90		
	ES-V95SDS	95	282	135
	ES-V100SDS	100		
	ES-V105SDS	105		
◎	ES-V110SDS	110		
	ES-V120SDS	120		
	ES-V130SDS	130		
	ES-V150SDS	150		
	ES-V155SDS	155		
△	ES-V160SDS	160		
	ES-V170SDS	170		
	ES-V200SDS	200		
	ES-V220SDS	220		

Single-function
Core Drill

E&S RC Type



- Adopts a sharp cutting-edge shape which enables speedy drilling only by rotation.
- Simultaneous pursuit of accuracy and efficiency. Sure and steady drilling is enabled even for fragile work materials.
- Uses "10 mm/13 mm chuck combination shank" allowing most drill chucks.
- SDS shanks are also available at the same price.

Effective Length Please refer to the spec table.

Applicable Electric Tool Electric Drill / Percussion Drill (rotating mode)

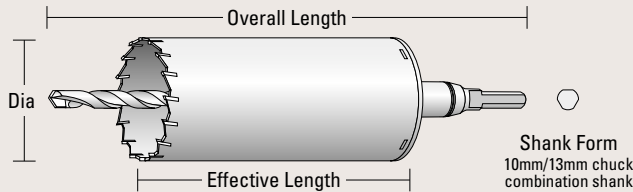

PVC	PLASTERBOARD	SLATE	BLOCK/BRICK
MORTAR	JAPANESE WALL	ROOF TILE	PORCELAIN TILE
PLASTIC	PORCELAIN PIPE	EXTERIOR PANELS	

CORE DRILLS

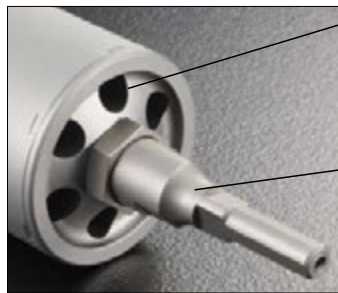

- Equipped with "drilling swarf discharge holes" in consideration of debris. Drilling swarf discharge holes for drills with a diameter of 22 - 38 mm positioned on the body side surface.
- "10mm/13mm chuck combination shank" allows for most drill chucks.

Cutting edge shape

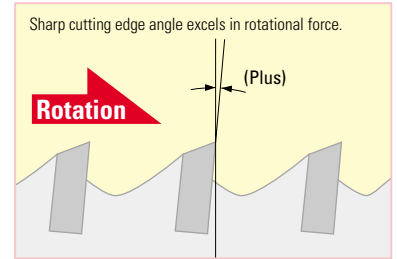

ES-R (Straight-Shank)				
	Code	Diameter (mm)	Overall Length (mm)	Effective Length (mm)
	ES-R22ST	22	235	135
	ES-R25ST	25	270	150
○	ES-R29ST	29		
△	ES-R32ST	32		
	ES-R35ST	35		
	ES-R38ST	38		
	ES-R40ST	40	269	135
	ES-R45ST	45		
○	ES-R50ST	50		
△	ES-R55ST	55		
	ES-R60ST	60		
◎	ES-R65ST	65		
	ES-R70ST	70		
	ES-R75ST	75		
◎	ES-R80ST	80		
	ES-R85ST	85		
○	ES-R90ST	90		
	ES-R95ST	95	269	135
	ES-R100ST	100		
	ES-R105ST	105		
	ES-R110ST	110		
◎	ES-R120ST	120		
△	ES-R130ST	130		
○	ES-R150ST	150		
	ES-R160ST	160		
◎	ES-R170ST	170		
	ES-R200ST	200		
△	ES-R220ST	220		

ES-R (SDS-Shank)				
	Code	Diameter (mm)	Overall Length (mm)	Effective Length (mm)
	ES-R25SDS	25	283	150
	ES-R29SDS	29		
	ES-R32SDS	32		
	ES-R35SDS	35		
	ES-R38SDS	38		
	ES-R40SDS	40	282	135
	ES-R45SDS	45		
○	ES-R50SDS	50		
	ES-R55SDS	55		
	ES-R60SDS	60		
○	ES-R65SDS	65		
	ES-R70SDS	70		
	ES-R75SDS	75		
△	ES-R80SDS	80		
	ES-R85SDS	85		
	ES-R90SDS	90		
	ES-R95SDS	95	282	135
△	ES-R100SDS	100		
	ES-R105SDS	105		
△	ES-R110SDS	110		
△	ES-R120SDS	120		
	ES-R130SDS	130		
	ES-R150SDS	150		
	ES-R160SDS	160		
△	ES-R170SDS	170		
	ES-R200SDS	200		
	ES-R220SDS	220		

CORE DRILLS

Single-function
Core Drill

E&S ALC Type



- Compatible with ALC features. Large-bore drilling realized for hard-to-drill materials of ALC panels.
- Outstanding rotational force enables easy cutting of ALC panels including piano wires and double reinforcement.
- Sharp drilling force is provided for the ultra-hard tips of cutting edges. Adopts high-toughness materials that excel in wear resistance.
- SDS shanks are also available at the same price.

ALC



ALC PANEL

PLASTERBOARD

Effective Length Please refer to the spec table.

Applicable Electric Tool Electric Drill / Percussion Drill (rotating mode)

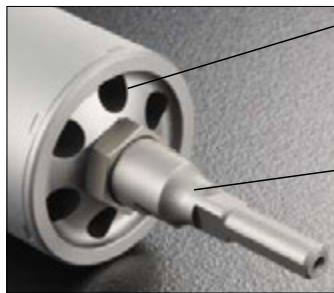
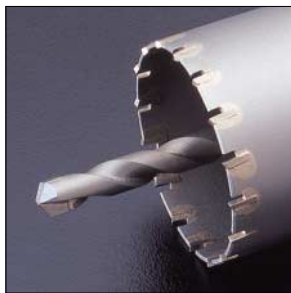
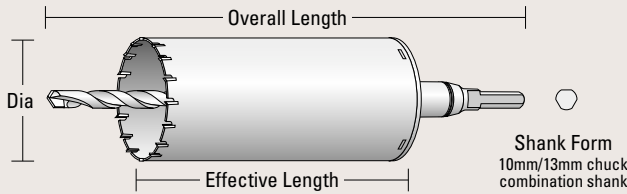

- Equipped with "drilling swarf discharge holes" in consideration of debris. Drilling swarf discharge holes for drills with a diameter of 22 - 38 mm positioned on the body side surface.
- "10mm/13mm chuck combination shank" allows for most drill chucks.

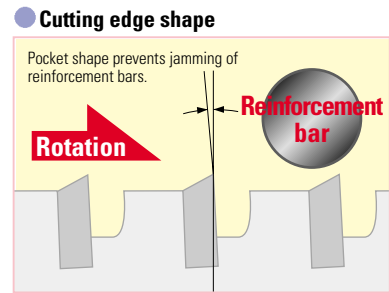

ES-A (Straight-Shank)				
	Code	Diameter (mm)	Overall Length (mm)	Effective Length (mm)
	ES-A22ST	22	235	135
	ES-A25ST	25	270	150
	ES-A29ST	29		
	ES-A32ST	32		
	ES-A35ST	35		
	ES-A38ST	38		
	ES-A40ST	40	269	135
	ES-A45ST	45		
◎	ES-A50ST	50		
	ES-A55ST	55		
	ES-A60ST	60		
◎	ES-A65ST	65		
	ES-A70ST	70		
	ES-A75ST	75		
○	ES-A80ST	80		
	ES-A85ST	85		
	ES-A90ST	90		
	ES-A95ST	95	269	135
	ES-A100ST	100		
	ES-A105ST	105		
△	ES-A110ST	110		
	ES-A120ST	120		
	ES-A130ST	130		
	ES-A150ST	150		
	ES-A155ST	155		
△	ES-A160ST	160		
	ES-A170ST	170		
	ES-A200ST	200		
	ES-A220ST	220		

ES-A (SDS-Shank)				
	Code	Diameter (mm)	Overall Length (mm)	Effective Length (mm)
	ES-A25SDS	25	283	150
	ES-A29SDS	29		
△	ES-A32SDS	32		
	ES-A35SDS	35		
	ES-A38SDS	38		
	ES-A40SDS	40	282	135
	ES-A45SDS	45		
◎	ES-A50SDS	50		
	ES-A55SDS	55		
	ES-A60SDS	60		
◎	ES-A65SDS	65		
◎	ES-A70SDS	70		
△	ES-A75SDS	75		
○	ES-A80SDS	80		
	ES-A85SDS	85		
	ES-A90SDS	90		
	ES-A95SDS	95	282	135
○	ES-A100SDS	100		
△	ES-A105SDS	105		
◎	ES-A110SDS	110		
	ES-A120SDS	120		
△	ES-A130SDS	130		
	ES-A150SDS	150		
△	ES-A155SDS	155		
◎	ES-A160SDS	160		
	ES-A170SDS	170		
	ES-A180SDS	180		
	ES-A200SDS	200		
○	ES-A210SDS	210		
	ES-A220SDS	220		
○	ES-A260SDS	260		

Single-function
Core Drill

E&S DC Type



- Capable of drilling reinforced concrete (cutting up to triple-reinforcement) by dry process without using water.
- Center pin positions only to reduce vibration and noise.
- Uses "10 mm/13 mm chuck combination shank" allowing most drill chucks.
- SDS shanks are also available at the same price.

*Use water for cooling the cutting edge when drilling ceramic tiles and stone.

Effective Length Please refer to the spec table.

Applicable Electric Tool Electric Drill / Percussion Drill (rotating mode)

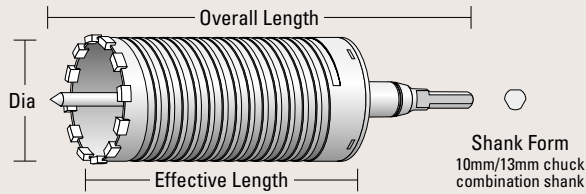

Dry Diamond

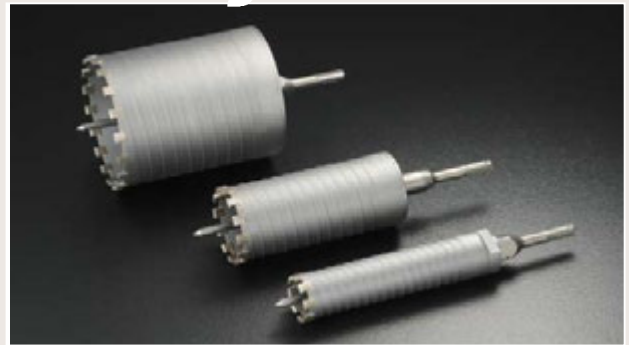

REINFORCED CONCRETE **HARD EXTERIOR PANEL**

Resin-based ARTIFICIAL MARBLE

MORTAR

EXTRUDED CEMENT PANEL

SOFT EXTERIOR PANEL

BLOCK / BRICK

* CERAMIC TILE

CORE DRILLS



Cutting edge shape

Using diamond particles, drilling is performed through grinding the worked on material.

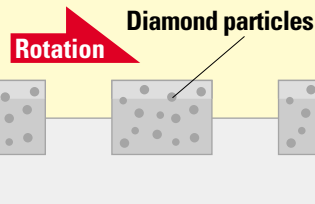

ES-D (Straight-Shank)

	Code	Diameter (mm)	Overall Length (mm)	Effective Length (mm)	
△	ES-D25ST	25	253	150	
△	ES-D29ST	29			
○	ES-D32ST	32			
○	ES-D35ST	35			
○	ES-D38ST	38			
	ES-D40ST	40	252	135	
	ES-D45ST	45			
○	ES-D50ST	50			
	ES-D55ST	55			
	ES-D60ST	60			
◎	ES-D65ST	65			
△	ES-D70ST	70			
	ES-D75ST	75			
	ES-D80ST	80			
	ES-D85ST	85			
	ES-D90ST	90			
	ES-D95ST	95	252	135	
	ES-D100ST	100			
	ES-D105ST	105			
	ES-D110ST	110			
	ES-D120ST	120			
	ES-D130ST	130			
	ES-D150ST	150			
	ES-D160ST	160			
	ES-D170ST	170			

ES-D (SDS-Shank)

	Code	Diameter (mm)	Overall Length (mm)	Effective Length (mm)	
△	ES-D25SDS	25	266	150	
○	ES-D29SDS	29			
◎	ES-D32SDS	32			
○	ES-D35SDS	35			
◎	ES-D38SDS	38			
△	ES-D40SDS	40	265	135	
	ES-D45SDS	45			
◎	ES-D50SDS	50			
	ES-D55SDS	55			
△	ES-D60SDS	60			
◎	ES-D65SDS	65			
○	ES-D70SDS	70			
	ES-D75SDS	75			
△	ES-D80SDS	80			
	ES-D85SDS	85			
	ES-D90SDS	90			
	ES-D95SDS	95	265	135	
	ES-D100SDS	100			
	ES-D105SDS	105			
	ES-D110SDS	110			
	ES-D120SDS	120			
	ES-D130SDS	130			
	ES-D150SDS	150			
△	ES-D160SDS	160			
	ES-D170SDS	170			

ES-DH For Hume Pipe (SDS-Shank)

Build to order

	Code	Diameter (mm)	Overall Length (mm)	Effective Length (mm)	
	ES-DH150SDS	150	265	135	
	ES-DH170SDS	170			
	ES-DH200SDS	200			
	ES-DH220SDS	220			

Handling Method

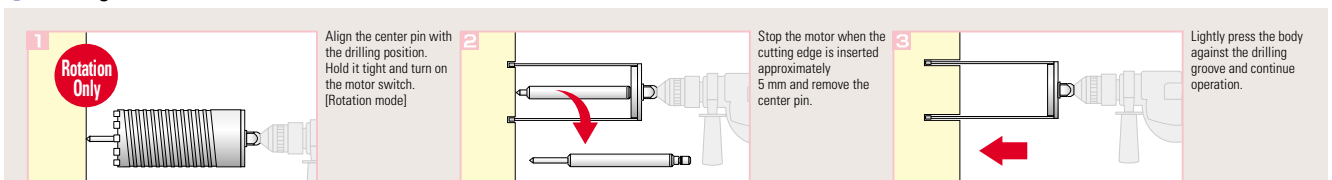

* ドレス (目立て・目出し) 作業についてはP.12をご覧ください。

CORE DRILLS

Single-function
Core Drill

E&S MC Type



- Multi-purpose in drilling in siding board walls, plasterboard, FRP, veneer panels, PVC panels, and compound materials etc.
- Pocket shape in consideration of swarf discharge efficiency also facilitates smooth drilling in thick panels and deep holes.
- SDS shanks are also available at the same price.

Multi



Effective Length Please refer to the spec table.
Applicable Electric Tool Electric Drill / Percussion Drill (rotating mode)

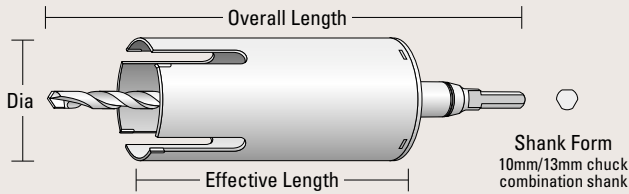

SOFT EXTERIOR PANEL	PVC
FRP	PLASTERBOARD
WOOD	PLYWOOD

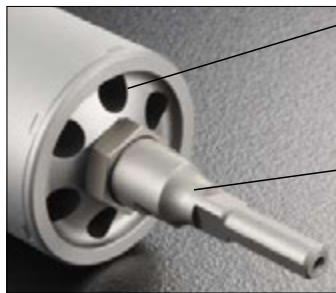

- Equipped with "drilling swarf discharge holes" in consideration of debris. Drilling swarf discharge holes for drills with a diameter of 22 - 38 mm positioned on the body side surface.
- "10mm/13mm chuck combination shank" allows for most drill chucks.

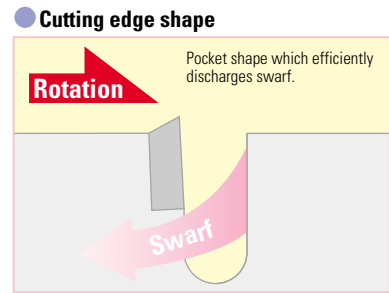

ES-M (Straight-Shank)				
	Code	Diameter (mm)	Overall Length (mm)	Effective Length (mm)
	ES-M25ST	25	270	150
	ES-M29ST	29		
⊙	ES-M32ST	32		
△	ES-M35ST	35		
○	ES-M38ST	38		
	ES-M40ST	40	269	135
	ES-M45ST	45		
△	ES-M50ST	50		
	ES-M55ST	55		
	ES-M60ST	60		
⊙	ES-M65ST	65		
○	ES-M70ST	70		
△	ES-M75ST	75		
	ES-M80ST	80		
	ES-M85ST	85		
	ES-M90ST	90		
	ES-M95ST	95	269	135
	ES-M100ST	100		
	ES-M105ST	105		
⊙	ES-M110ST	110		
	ES-M120ST	120		
	ES-M130ST	130		
	ES-M150ST	150		
	ES-M155ST	155		
△	ES-M160ST	160		
	ES-M170ST	170		

ES-M (SDS-Shank)				
	Code	Diameter (mm)	Overall Length (mm)	Effective Length (mm)
	ES-M25SDS	25	283	150
	ES-M29SDS	29		
⊙	ES-M32SDS	32		
	ES-M35SDS	35		
	ES-M38SDS	38		
○	ES-M40SDS	40	282	135
	ES-M45SDS	45		
△	ES-M50SDS	50		
	ES-M55SDS	55		
	ES-M60SDS	60		
⊙	ES-M65SDS	65		
	ES-M70SDS	70		
	ES-M75SDS	75		
○	ES-M80SDS	80		
	ES-M85SDS	85		
	ES-M90SDS	90		
	ES-M95SDS	95	282	135
△	ES-M100SDS	100		
	ES-M105SDS	105		
○	ES-M110SDS	110		
	ES-M120SDS	120		
	ES-M130SDS	130		
	ES-M150SDS	150		
	ES-M155SDS	155		
○	ES-M160SDS	160		
	ES-M170SDS	170		

Single-function
Core Drill

E&S FC Type



- Adopting unique double blade features, with the inner-blade preceding the outer-blade, boring through material such as; metallic siding, stainless steel/wood siding as well as compound materials (metallic plate + insulating material + plywood) at one go is possible.
- Swarf is efficiently discharged in boring wooden materials. It is also possible to bore through several layers of thin steel plates.
- SDS shanks are also available at the same price.

Effective Length Please refer to the spec table.

Applicable Electric Tool Electric Drill / Percussion Drill (rotating mode)

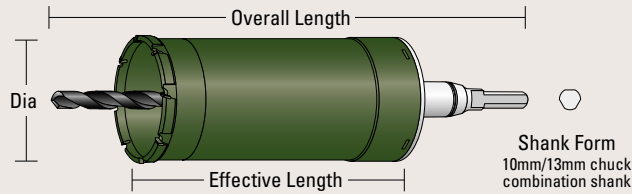

Compound Material



STEEL / ALUMINUM

METAL SIDING PANEL

2x4's including nails

WOOD / PLYWOOD

PVC / FRP

PLASTERBOARD

STAINLESS STEEL

CORE DRILLS

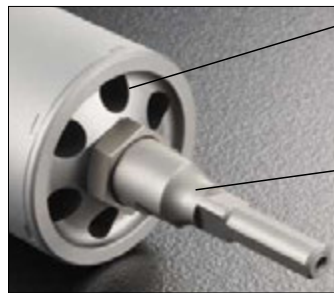

- Equipped with "drilling swarf discharge holes" in consideration of debris. Drilling swarf discharge holes for drills with a diameter of 22 - 38 mm positioned on the body side surface.
- "10mm/13mm chuck combination shank" allows for most drill chucks.

Cutting edge shape

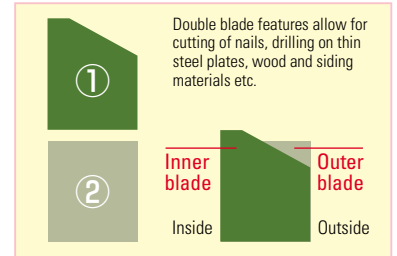

ES-F (Straight-Shank)

	Code	Diameter (mm)	Overall Length (mm)	Effective Length (mm)	
	ES-F25ST	25	270	150	
	ES-F29ST	29			
○	ES-F32ST	32			
○	ES-F35ST	35			
	ES-F38ST	38			
	ES-F40ST	40	269	135	
	ES-F45ST	45			
△	ES-F50ST	50			
	ES-F55ST	55			
	ES-F60ST	60			
◎	ES-F65ST	65			
	ES-F70ST	70			
	ES-F75ST	75			
○	ES-F80ST	80			
	ES-F85ST	85			
△	ES-F90ST	90			
	ES-F95ST	95	269	135	
△	ES-F100ST	100			
	ES-F105ST	105			
○	ES-F110ST	110			
	ES-F120ST	120			
	ES-F130ST	130			
	ES-F150ST	150			
	ES-F155ST	155			
△	ES-F160ST	160			
	ES-F170ST	170			

ES-F (SDS-Shank)

	Code	Diameter (mm)	Overall Length (mm)	Effective Length (mm)	
	ES-F25SDS	25	283	150	
	ES-F29SDS	29			
◎	ES-F32SDS	32			
○	ES-F35SDS	35			
◎	ES-F38SDS	38			
	ES-F40SDS	40	282	135	
	ES-F45SDS	45			
◎	ES-F50SDS	50			
	ES-F55SDS	55			
	ES-F60SDS	60			
◎	ES-F65SDS	65			
○	ES-F70SDS	70			
	ES-F75SDS	75			
△	ES-F80SDS	80			
	ES-F85SDS	85			
	ES-F90SDS	90			
	ES-F95SDS	95	282	135	
	ES-F100SDS	100			
	ES-F105SDS	105			
◎	ES-F110SDS	110			
△	ES-F120SDS	120			
	ES-F130SDS	130			
	ES-F150SDS	150			
	ES-F155SDS	155			
○	ES-F160SDS	160			
	ES-F170SDS	170			

CORE DRILLS



**Braze Diamond Core Drill
For PVC Pipe**

VPC Type



- Diamond abrasive grit most suitable for drilling in polyvinyl chloride pipe to the cutting edge.
- Prevents drill stopping when drilling rib pipe to achieve stable operation with no burrs.
- Expands the "drilling swarf discharge hole" on the flange part to reduce weight.
- Adopts center pin system enabling simple center positioning.

Effective Length 110 mm

Applicable Electric Tool

Electric Drill / Percussion Drill (rotating mode)

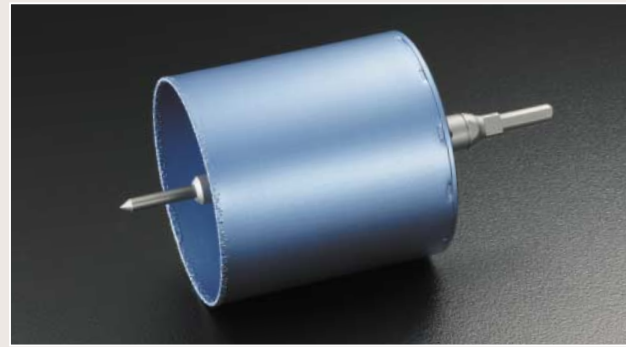
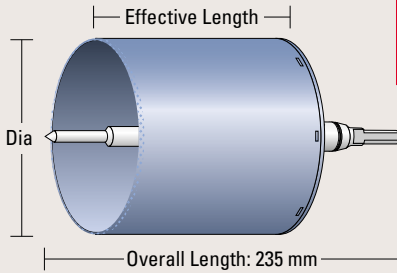

VU PIPE	RIB PIPE
FRPM PIPE	PVC PIPE
MARBLE PANEL	SOFT EXTERIOR PANEL

*This drill cannot be used on metallic pipes such as spiral pipes and cast-iron pipes, and metallic plates.

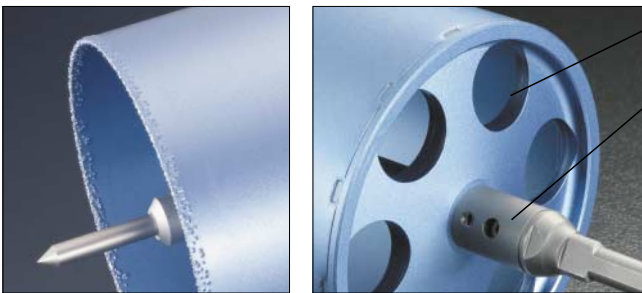

- Equipped with "drilling swarf discharge holes" in consideration of debris.
- "10mm/13mm chuck combination shank" allows for most drill chucks.

● Features of braze diamond

- Minimal amount of diamond dislodging, longer life and more grinding force in comparison with electrodeposition because the diamonds are firmly bonded.
- Less clogging and stable sharpness because diamonds are largely protruded and the space between them are deep.

● Appropriate motor

- Power consumption: 500W 8A or more
- Rotation speed: 700rpm or more

⚠ Precautions on use

- Braze diamond is only in dry conditions. Do not use water.
- Dressing is unnecessary for braze diamond.
- Braze diamond cannot be used for steel pipes such as spiral pipes and duct pipes.



● Handling Method

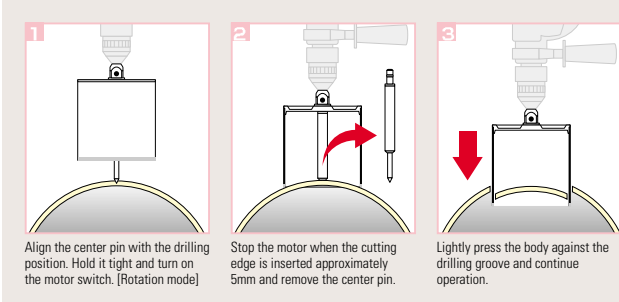

BZ-VPC (Straight-Shank)

Code	Diameter (mm)	Center Pin (code)
BZ-VPC120ST	120	BZCP-Nb.1
BZ-VPC170ST	170	
BZ-VPC220ST	220	

BZ-VPC (Center Pin)

Code	Diameter (mm)	Core Drill Size (mm)
BZCP-Nb.1	169	120~220

BZ-VPC (Center Drill)

Code	Diameter (mm)	Overall Length (mm)	Core Drill Size (mm)
BZCD-Nb.1	10.0	180	120~220

● Matching table of sockets installed for PVC pipes

Core Drill Size (mm)	Nominal diameter of pipe installed socket (mm)
120	100
170	150
220	200

*Make sure to pay attention to the nominal diameter of socket and actual prepared hole size.



**Braze Diamond Core Drill
For Ventilating Fan**

FAN Type



- Diamond abrasive grit most suitable for drilling in ALC panels to the cutting edge.
- Smoothly cuts piano wire and triple reinforcement, including ALC panels. Prevents drill stopping.
- Expands the "drilling swarf discharge hole" on the flange part to reduce weight.
- Adopts a center pin system enabling simple center positioning.

Effective Length 160 mm

Applicable Electric Tool

Electric Drill / Percussion Drill
(rotating mode)

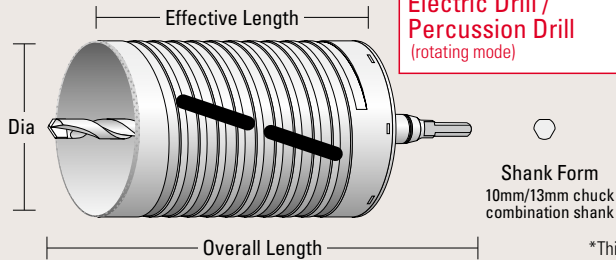

ALC PANEL (also cutting piano wire and triple reinforcement)

MARBLE PANEL

SOFT EXTERIOR PANEL

*This core drill cannot be used for metallic plates, metallic pipes, wood, mortar, blocks and concrete.

CORE DRILLS



- Equipped with "drilling swarf discharge holes" in consideration of debris.
- "10mm/13mm chuck combination shank" allows for most drill chucks.

Features of brazed diamond

- Minimal amount of diamond dislodging, longer life and more grinding force in comparison with electrodeposition because the diamonds are firmly bonded.
- Less clogging and stable sharpness because diamonds are largely protruded and the space between them are deep.

Appropriate motor

- Power consumption: 750W 8A or more
- Rotation speed: 800rpm or more

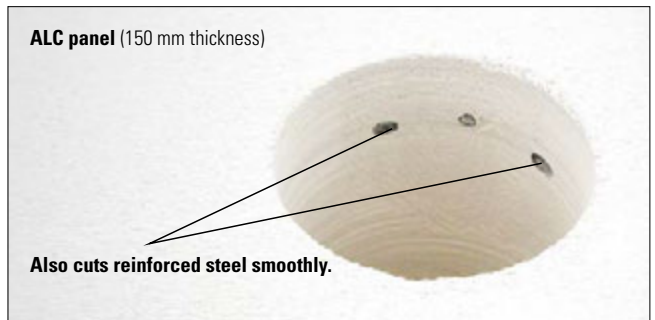

⚠ Precautions on use

- Braze diamond is only in dry conditions. Do not use water.
- Dressing is unnecessary for braze diamond.
- Braze diamond cannot be used for metallic plates, metallic pipes, and wood.
- Braze diamond cannot be used for mortar, block and concrete.

BZ-FAN (Straight-Shank)				
Code	Diameter (mm)	Overall Length (mm)	Center Drill (code)	
BZ-FAN65ST	65	299	BZCD	
BZ-FAN70ST	70		-No.2	
BZ-FAN80ST	80			
BZ-FAN95ST	95			
BZ-FAN110ST	110			
BZ-FAN160ST	160			

BZ-FAN (SDS-Shank)				
Code	Diameter (mm)	Overall Length (mm)	Center Drill (code)	
BZ-FAN65SD	65	312	BZCD	
BZ-FAN70SD	70		-No.2	
BZ-FAN80SD	80			
BZ-FAN95SD	95			
BZ-FAN110SD	110			
BZ-FAN160SD	160			

BZ-FAN (Center Drill)				General attachment
Code	Diameter (mm)	Overall Length (mm)	Core Drill Size (mm)	
BZCD-No.2	10.0	250	65~160	

BZ-FAN (Center Pin)				Optional product
Code	Overall Length (mm)	Core Drill Size (mm)		
BZCP-No.2	216	65~160		

Diamond Core Drill **DC** Type



- Drill reinforced concrete (up to 10mm-reinforced) with hardly any impact, low noise, and low load.
- Easy-to-use center pin system enabling simple center positioning.



Effective Length 150 mm (Dia:29-38mm) / 130 mm (Dia:50-120mm)

Applicable Electric Tool Electric Drill / Percussion Drill (rotating mode)

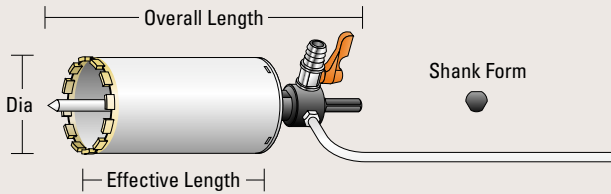

CONCRETE	STONE	Resin-based ARTIFICIAL MARBLE
MORTAR	HARD EXTERIOR PANELS	
BLOCK / BRICK	SLATE	ROOF TILE
CERAMIC TILE	PORCELAIN TILE	SOFT EXTERIOR PANELS

● Appropriate motor

- Power consumption: 500W or more
- Rotation speed: 1000 - 1400rpm or more

⚠ Precautions on use

- Diamond burns and carbonized at high temperatures. Water must be provided during drilling operations to cool the diamond tip.
- Make sure to remove the center pin once the drilling point is positioned.
- Avoid cutting the reinforcement wherever possible since it relates to the strength of the structure.

● Extention shank

- Use by inserting between body and water feed shank.



● Handling Method

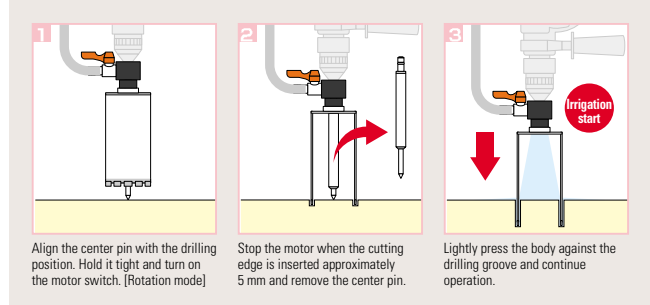

DC (Set)		Diameter (mm)	Overall Length (mm)	Center Pin (code)
ST-Shank	SDS-Shank			
DC-29S	DC-29SDS	29	282	DWP-No.0
DC-32S	DC-32SDS	32	SDS (306)	
DC-35S	DC-35SDS	35		
DC-38S	DC-38SDS	38		
DC-50S	DC-50SDS	50	263	DWP-No.1
DC-60S	DC-60SDS	60	SDS (287)	
DC-65S	DC-65SDS	65		
DC-70S	DC-70SDS	70		
DC-75S	DC-75SDS	75		
DC-80S	DC-80SDS	80		
DC-100S	DC-100SDS	100		
DC-110S	DC-110SDS	110		
DC-120S	DC-120SDS	120		

DC (Body)		Body Length (mm)
Code		
DC-29B		170
DC-32B		
DC-35B		
DC-38B		
DC-50B		155
DC-60B		
DC-65B		
DC-70B		
DC-75B		
DC-80B		
DC-100B		
DC-110B		
DC-120B		

DC (Lubricate Shank)			
Code	Overall Length (mm)	Socket Diameter (mm)	Shank Type
DS-1	118	16	Straight
DS-SDS	142	16	SDS

DC (Center Pin)		
Code	Overall Length (mm)	Core Drill Size (mm)
DWP-No.0	207	29~38
DWP-No.1	187	50~120

DC (Extention Shank)		
Code	Overall Length (mm)	Application
DLS-220	220	Should be used for deep holes or penetrating thick walls.

DC (L-type Stopper)	
Code	
DC-L	

Rotary Hammer Core Drill **LHC** Type



- Large-bore drilling is possible even with small, lightweight hammer drills which have low striking force.
- Reduced body thickness and application of special hardening process makes possible high-speed drilling with durability.
- The inclusion of spiral design for swift swarf removal.
- Center pin does not require guide plate.

Effective Length 80 mm

Applicable Electric Tool Rotary Hammer Drill (SDS)

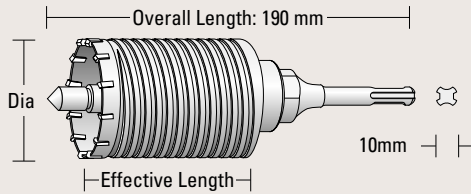

CONCRETE
MORTAR

BLOCK / BRICK
SLATE

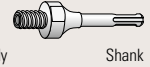
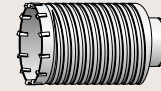
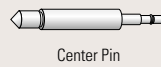

Handling Method



1 Screw the shank into the core drill body.



2 Insert and set the center pin while aligning it with hole on the tip end of the shank.



3 Attach to the lightweight hammer drill. This completes preparation.



4 Only the center pin is required for positioning. Once complete positioning is made by drilling to a depth of approximately 5 mm, pull out the center pin and continue drilling operation.

LHC (Set)			
Code	Diameter (mm)	LHC Shank Code x Length (mm)	Center Pin (code)
LHC-25	25	No.1×105	No.3
LHC-29	29		
LHC-32	32		
LHC-35	35		
LHC-38	38		
LHC-50	50	No.2×105	No.3
LHC-55	55		
LHC-60	60		
LHC-65	65		
LHC-70	70		
LHC-75	75		
LHC-80	80		

LHC (Body)		
Code	Diameter (mm)	Body Length (mm)
LHC-25B	25	105
LHC-29B	29	
LHC-32B	32	
LHC-35B	35	
LHC-38B	38	
LHC-50B	50	105
LHC-55B	55	
LHC-60B	60	
LHC-65B	65	
LHC-70B	70	
LHC-75B	75	
LHC-80B	80	

LHC (Shank)		
Code	Overall Length (mm)	Core Drill Size (mm)
LHCSK No.1X105	105	25~38 (Standard)
LHCSK No.1X300	300	25~38 (Long shank)
LHCSK No.2X105	105	50~80 (Standard)
LHCSK No.2X300	300	50~80 (Long shank)

LHC (Center Pin)		
Code	Overall Length (mm)	Core Drill Size (mm)
LHCCP No.3	116	25~80

*Center pin required only for positioning is fully made by drilling approx. 5mm, the center pin should be removed and drilling continued.

*Shank configurations are all SDS type.

Hammer Core Drill **HC** Type



- Smoothly transmit powerful hammering and rotation force to offer rapid drilling through reinforced concrete (up to 10mm-reinforced).
- Extremely thin body incorporates double spiral to eliminate dispersion of drilling force due to swarf. Speed increased 20% or more compared with conventional products.
- Cope with thick concrete by using shank sizes up to 450mm long.

Effective Length 100 mm

Applicable Electric Tool Hammer Drill

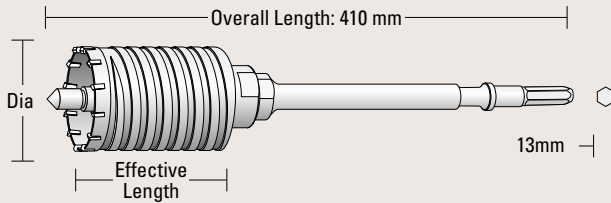

CONCRETE

BLOCK / BRICK

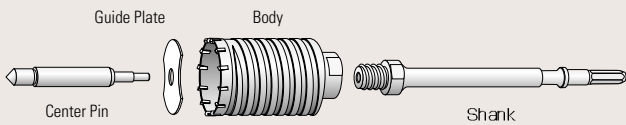

HC (Set)			
Code	Diameter (mm)	HC Shank Code x Length (mm)	Center Pin (code)
HC-25	25	No.1×300	—
HC-29	29		
HC-32	32	No.1×300	No.1
HC-35	35		
HC-38	38	No.2×300	No.2
HC-45	45		
HC-50	50		
HC-55	55		
HC-60	60		
HC-65	65		
HC-70	70		
HC-75	75		
HC-80	80		
HC-95	95		
HC-105	105		
HC-110	110		
HC-120	120		
HC-130	130		
HC-150	150		

HC (Body)			With guide plate	
Code	Diameter (mm)	Body Length (mm)		
*HC-25B	25	150		
*HC-29B	29			
HC-32B	32	150		
HC-35B	35			
HC-38B	38	150		
HC-45B	45			
HC-50B	50			
HC-55B	55			
HC-60B	60			
HC-65B	65			
HC-70B	70			
HC-75B	75			
HC-80B	80			
HC-95B	95			
HC-105B	105			
HC-110B	110			
HC-120B	120			
HC-130B	130			
HC-150B	150			

*No guide plate as center pin not required.

HC (Shank)			
Code	Overall Length (mm)	Core Drill Size (mm)	
HCSK-No.1X200	200	25~35	
HCSK-No.1X300	300	25~35 (Standard)	
HCSK-No.1X450	450	25~35 (Long shank)	
HCSK-No.2X200	200	38~150	
HCSK-No.2X300	300	38~150 (Standard)	
HCSK-No.2X450	450	38~150 (Long shank)	

HC (Center Pin)			
Code	Overall Length (mm)	Core Drill Size (mm)	
HCCP-No.1	135	32~35	
HCCP-No.2	126	38~150	

Drilling test data

Demonstrates 20 % increase in speed over previous products.
 [When drilling reinforced concrete (250 kg/cm² compressive strength) with HC 75 mm]

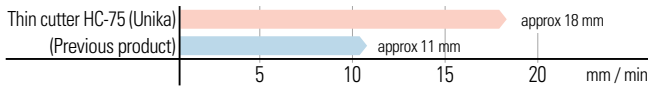

*Triple-reinforced requires 7 - 8 mins, double-reinforced requires 3 - 4 mins.

Drilling test

Test conditions

Core size used / 55 mm
 Material / Concrete (strength 250 kg)
 Drill depth / 100 mm

Test results

Drilling time / 5 mins
 No. of times maintained / Over 100 times

Handling Method



1 Screw the shank into the core drill body.
 *When removing the core body and the shank, place the body facing upward while inserted into the main unit and strike a few times to loosen the round screw.



2 Insert and set the center pin while aligning it with hole on the tip end of the shank. Attach a guide plate to the set center pin.



3 Attach to the hammer drill as in the case with the conventional hexagonal shank drill and bull point.



4 Only the center pin is required for positioning. Pull out the center pin once the work material is drilled to a depth of approximately 5 mm and the drill tip end stops turning, then continue drilling operation.

HC (Guide Plate)

Code	Diameter (mm)		
HCGP-32	32		
HCGP-35	35		
HCGP-38	38		
HCGP-45	45		
HCGP-50	50		
HCGP-55	55		
HCGP-60	60		
HCGP-65	65		
HCGP-70	70		
HCGP-75	75		
HCGP-80	80		
HCGP-95	95		
HCGP-105	105		
HCGP-110	110		
HCGP-120	120		
HCGP-130	130		
HCGP-150	150		

Compatible Motors

	Manufacturer	Model No.
Hammer Drill	HITACHI	PR25B
		DH35
		PR38E
		DH40SA
		DH40SR
		DH45SA
	MAKITA	HR3520
		HR3530
		HR3850
		HR3811
		HR4030C
	RYOBI	ED-383N
		ED-382NA
		ED-382NPA

CORE DRILLS



Lined writing area consisting of 25 horizontal red lines spaced evenly down the page.

CORE DRILLS

unika

www.unika.co.jp

UNIKA CO., LTD.

2-10-6, IWAMOTO-CHO, CHIYODA-KU, TOKYO 101-0032 JAPAN
Tel: +81-3-3864-3321 Fax: +81-3-3864-7746

SERIES CATALOGUE

UR 21

CORE DRILLS

HOLE SAWS

CONCRETE DRILLS

ANCHORS